

00-16941

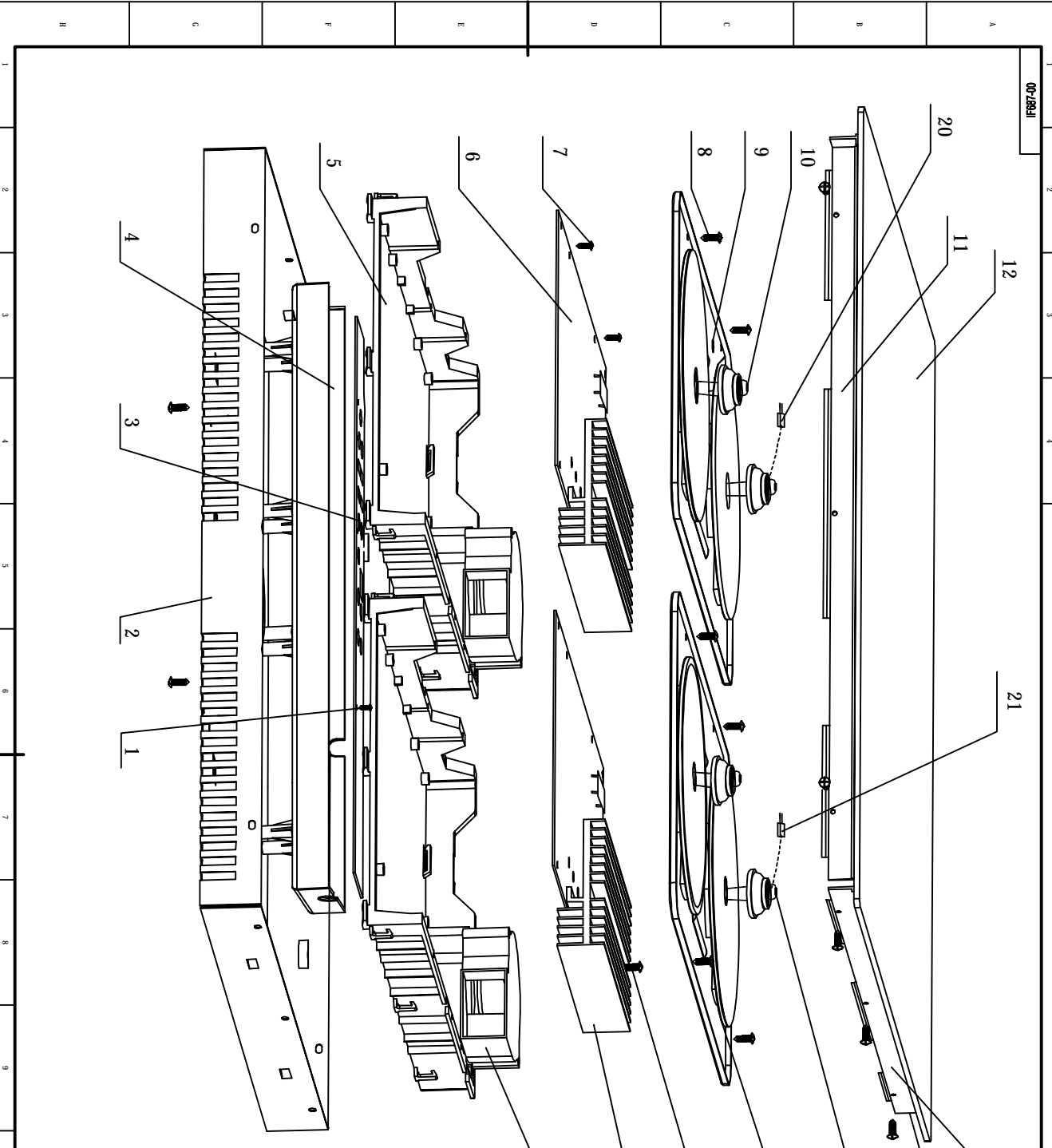

21	301328100127	Variable Control	1	1	Assembly	FR02-12
20	301328100128	Variable Control	1	1	Assembly	FR02-11
19	301328100316	Fan	2	2	ICM7 4.1A, incl. 200	FR02-05
18	301340010162	Headlink	2	2	CSM 0712027PNC	FR02-18
17	301340010162	Screw	6	6	CSM 0712027PNC	FR02-18
16	301328100105	Callignment	2	2	Assembly	FR02-14
15	301328100105	Variable Component	2	2	Assembly	FR02-14
14	301327900014	Connecting Plate	1	1	SGCC T10	FR02-05-02
13	301327900015	Connecting Plate	2	2	SGCC T10	FR02-05-02
12	301327900071	Ceramic Glass	1	1	4.5x3.0x3.0	FR02-05-02
11	301327900071	Connecting Plate	1	1	SGCC T10	FR02-05-02
10	301328100104	Variable Component	2	2	Assembly	FR02-14
9	301328100104	Motor Mount	2	2	Assembly	FR02-14
8	301340010264	Screw	22	22	ESM 011700027816	FR02-05-02
7	301340010265	Screw	21	21	ESM 011700027816	FR02-05-02
6	301328100105	Main control board	2	2	FR02-12	FR02-05-02
5	301327900005	Printbook	2	2	pp 725	FR02-05-02
4	301327900117	Display Panel	1	1	pp 720	FR02-05-02
3	301327900149	Display Board	1	1	FR02-05-02	FR02-05-02
2	301327900024	Base	1	1	SGCC T08	FR02-05-02
1	301340010167	Screw	8	8	CSM 0712027PNC	FR02-18

CODE **NAME** **QTY** **MATERIAL** **UNIT** **REMARK**
 FR02-12 Main control board 2 FR02-12 FR02-05-02
 FR02-11 Variable Control 1 Assembly FR02-14
 FR02-05 Fan 2 ICM7 4.1A, incl. 200 FR02-05-02
 FR02-18 Headlink 2 CSM 0712027PNC FR02-18
 FR02-14 Callignment 2 Assembly FR02-14
 FR02-14 Variable Component 2 Assembly FR02-14
 FR02-05-02 Connecting Plate 1 SGCC T10 FR02-05-02
 FR02-05-02 Connecting Plate 2 SGCC T10 FR02-05-02
 FR02-05-02 Ceramic Glass 1 4.5x3.0x3.0 FR02-05-02
 FR02-05-02 Connecting Plate 1 SGCC T10 FR02-05-02
 FR02-14 Variable Component 2 Assembly FR02-14
 FR02-14 Motor Mount 2 Assembly FR02-14
 FR02-05-02 Screw 22 ESM 011700027816 FR02-05-02
 FR02-05-02 Screw 21 ESM 011700027816 FR02-05-02
 FR02-12 Main control board 2 FR02-12 FR02-05-02
 FR02-05-02 Printbook 2 pp 725 FR02-05-02
 FR02-05-02 Display Panel 1 pp 720 FR02-05-02
 FR02-05-02 Display Board 1 FR02-05-02 FR02-05-02
 FR02-05-02 Base 1 SGCC T08 FR02-05-02
 FR02-18 Screw 8 CSM 0712027PNC FR02-18